

52cm General Purpose Truss

52cm General Purpose truss manufactured from 6082-T6 Aluminium using 5.08cm x 3.2mm wall and 2.54cm x 3.2mm wall tubes. It is supplied as standard with Thomas truss bolts and nuts. This truss is suitable for the majority of lighting applications, flying P.A. and any general purpose use. It can be used with Ground Support System by incorporating suitable sleeve blocks. This truss can also be supplied with castor wheels at additional cost.

PRODUCT CODE	DESCRIPTION	WT kgs
B4400	4 metre Section	52
B4401	3 metre Section	40
B4402	2.5 metre Section	35
B4403	2 metre Section	31
B4404	1.5 metre Section	27
B4405	1 metre Section	20
B4450	0.5 metre Section	13
B4406	2 Way Corner Block	15
B4415	3 Way Corner Block	16
B4407	4 Way Corner Block	17
B4407A	5 Way Corner Block	18
B4408	6 Way Corner Block	19
B4409	0 - 270 ° Pivot Section	19.5
B4410	0 - 90 ° Pivot Section	19
B4411	0 - 180 ° Flat Pivot Section	17
B4412	GP To GP Triangular Adaptor	-
B4413	52cm GP To 30.5cm GP Adaptor	-
B1312	Lifting point	7
PRODUCT CODE	TRUSS WITH CASTORS	WT kgs
B4420	4 metre Section	60
B4421	3 metre Section	48
B4422	2.5 metre Section	43
B4423	2 metre Section	39
B4424	1.5 metre Section	35
B4425	1 metre Section	28

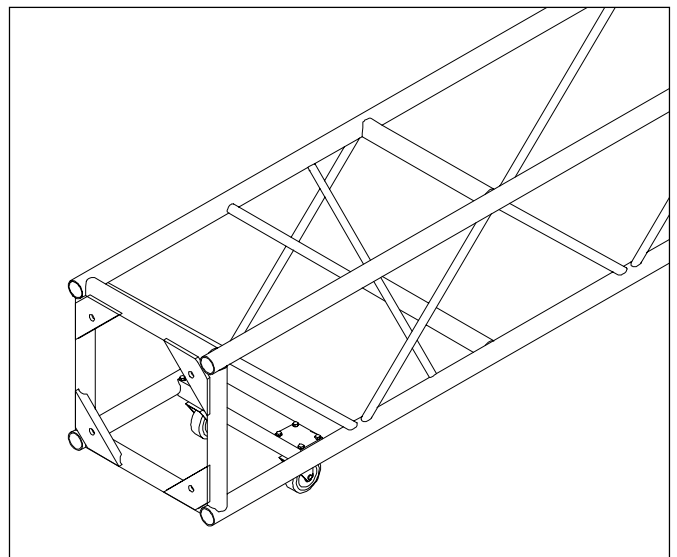
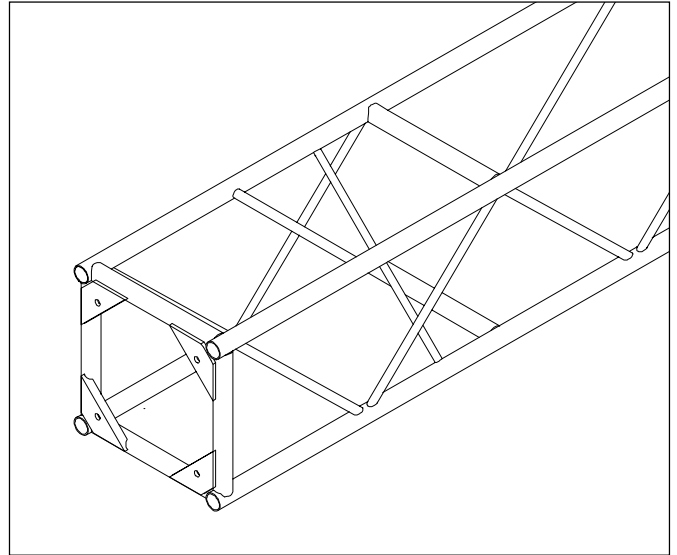

LOADING FIGURES show maximum loads between supports in addition to self weight of truss. Information extracted from structural report by The Broadhurst Partnership for truss manufactured after October 1988.

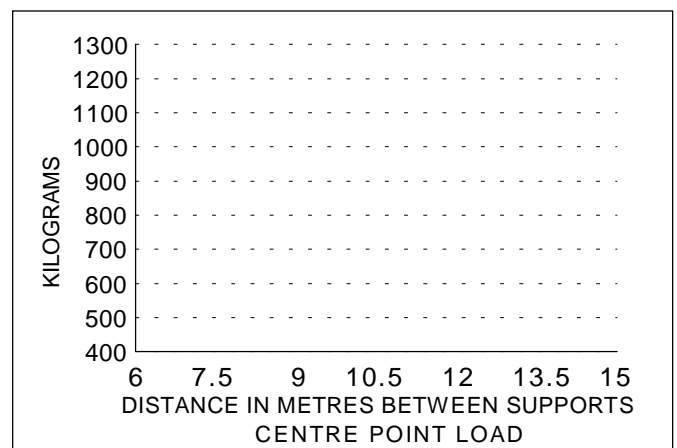

52cm General Purpose Truss

3 metre Section

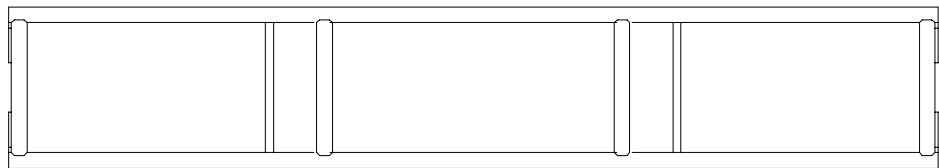
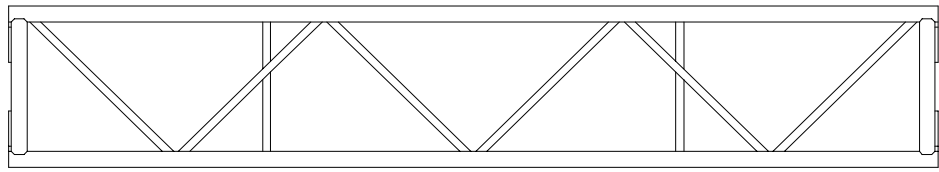
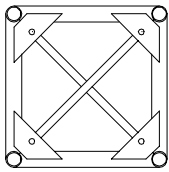
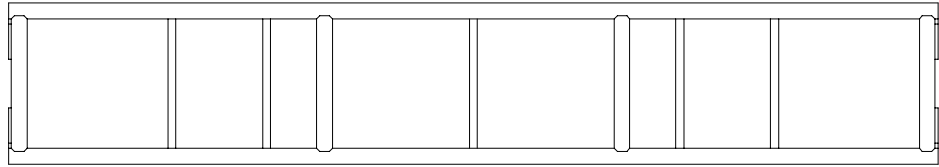

2 Way Corner Block

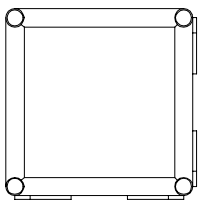

4 Way Corner Block

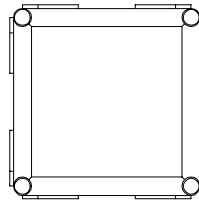

6 Way Corner Block

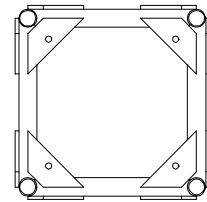

Universal Pivot Section
 90-0-90 Degrees

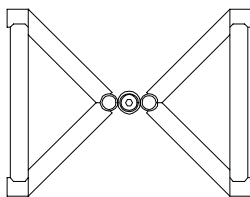

Universal Pivot Section
 0-270 Degrees

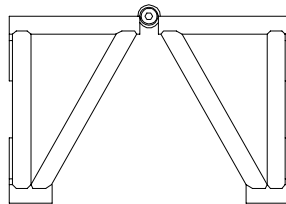

Flat Pivot Section
 0-180 Degrees

